

**CORNER RECORD**

Document Number CR 9661

City of BERKELEY

County of ALAMEDA, California

Brief Legal Description WELL MONUMENT LOCATED WITHIN THE INTERSECTION OF ROSE STREET AND HENRY STREET. (CITY OF BERKELEY: B0715)

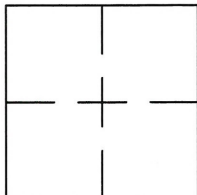

**CORNER RECORD**

Government Corner ☐ Control ☒  
 Meander ☐ Property ☐  
 Rancho ☐ Other ☐  
 Date of Survey 1/19/2017

**COORDINATES**  
(Optional)

N. \_\_\_\_\_  
 E. \_\_\_\_\_  
 Zone \_\_\_\_\_ Datum \_\_\_\_\_  
 Elev. \_\_\_\_\_

**Corner** — Left as found ☐ Found and tagged ☐ Established ☐ Reestablished ☒ Rebuilt ☐

Identification and type of corner found: Evidence used to identify or procedure used to establish or reestablish the corner:  
SET BRASS DISC WITH PUNCH STAMPED LS 4520 IN STANDARD MONUMENT WELL.

SEE CR 7123 (68 CR 7)

THIS POINT WAS INSTALLED AFTER A CONSTRUCTION PROJECT IN THE AREA.

A description of the physical condition of the monument as found and as set or reset: \_\_\_\_\_

FOUND AND SET POINTS AS SHOWN ON PAGE 2.

THESE TIES ARE FOR THE PURPOSE OF PERPETUATING THE FOUND MONUMENTATION.

NO CLAIM IS MADE AS TO THE RELATIONSHIP OF THE POINTS OR LINES SHOWN HEREON TO TRUE BOUNDARY LOCATIONS.

**SURVEYOR'S STATEMENT**

This Corner Record was prepared by me or under my direction in conformance with the Land Surveyors' Act on JANUARY 22, 2017.

Signed Vincent H. Cunha L.S. Number LS 4520  
VINCENT H. CUNHA



**COUNTY SURVEYOR'S STATEMENT**

This Corner Record was received 26 JANUARY 2017 and examined and filed 2 JUNE 2017.

Signed Michael Rubner Title COUNTY SURVEYOR

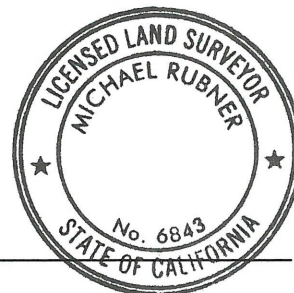

**County Surveyor's Comment** \_\_\_\_\_



SCALE: 1"=20'

## LEGEND

- SET BRASS DISK WITH PUNCH  
STAMPED LS 4520 IN MONUMENT WELL
- ✕ FOUND CUT CROSS IN CONCRETE (CR 7123)  
C.O.B. CITY OF BERKELEY
- AA##A# ALAMEDA COUNTY MONUMENT I.D.

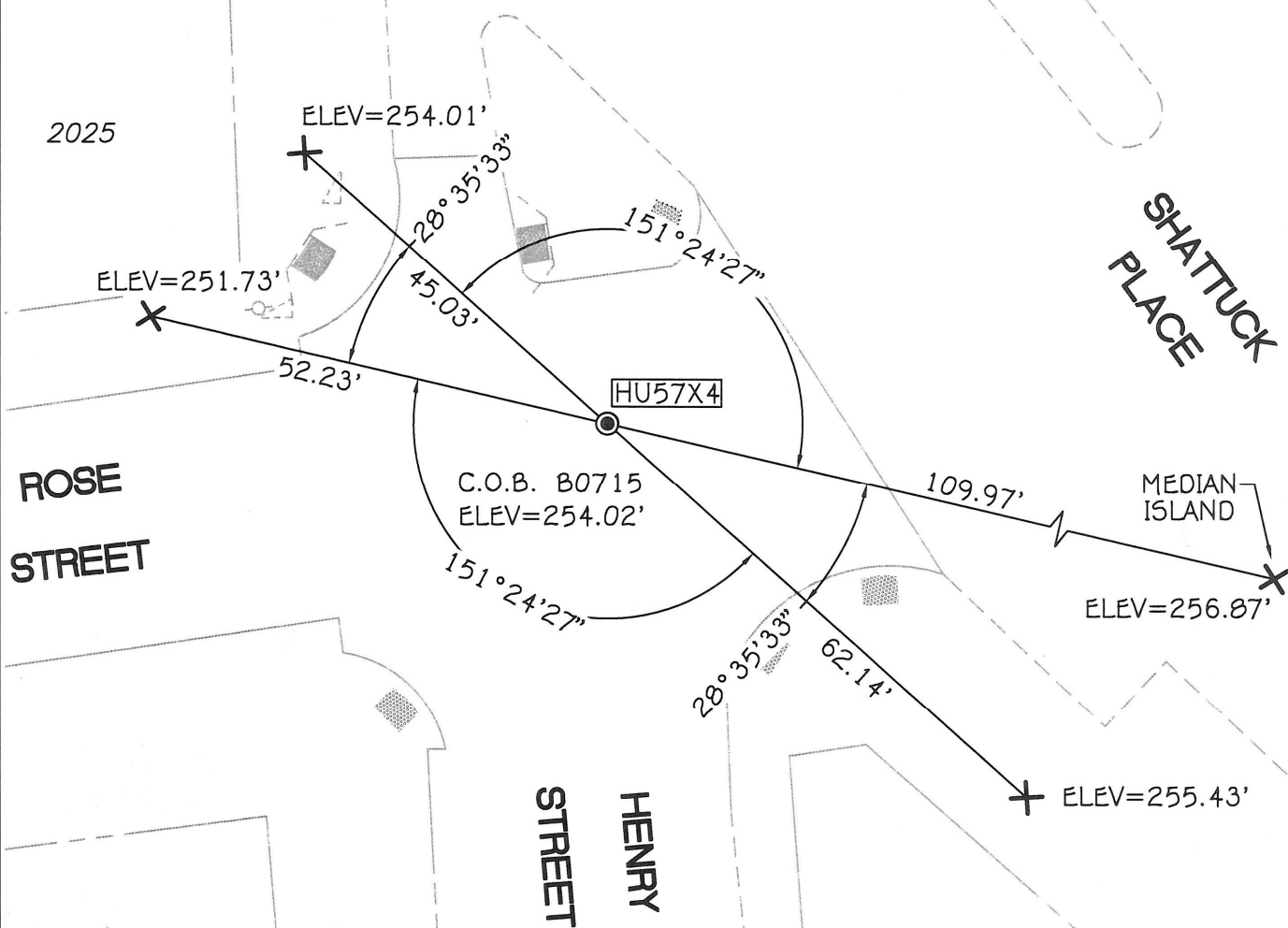

## NOTE

ELEVATIONS SHOWN HEREON ARE BASED UPON  
CITY OF BERKELEY VERTICAL DATUM.  
AS SHOWN ON CR 7123 (68 CR 7)

216010-K\ROSE\CR-2