

| MONUMENT LIST | | | | | |
|---------------|---|-------------------------------|-----|---|-------------------------------|
| M-1 | FD ROCK MOUND FOR QUARTER-CORNER SEC. 2, T.6 N., R.10 E., & SEC. 35, T.7 N., R.10 E., NO RECORD | N 583178.712 E 2100820.895 | M-4 | FD 2" IRON PIPE WITH BRASS CAP FOR CORNER TO TOWNSHIPS 6 & 7 NORTH, RANGES 10 & 11 EAST, M.D.M. [R-30] | N 583188.068 E 2103242.925 |
| M-2 | FD 1-3/4" IRON PIPE FOR CORNER TO SECS. 1, 2, 12 & 11, T.6 N., R.10 E., NO RECORD | N 581645.087 E 2101699.210 | M-5 | FD 1-1/4" IRON PIPE WITH 2"CAP FOR CORNER TO SECS. 1 & 12, T.6 N., R.10 E., AND SECS. 6 & 7, T.6 N., R.11 E., [R-31] | N 581596.943 E 2103312.765 |
| M-3 | FD FENCE CORNER POST IN ROCK MOUND FOR CORNER TO SECS. 25, 26, 35 & 36, T.7 N., R.10 E., [R-31] | N 584801.008 E 2101646.588 | M-6 | FD 2" IRON BAR WITH 3"CAP LS 3488 FOR CORNER TO SECS. 12 & 13, T.6 N., R.10 E., AND SECS. 7 & 18, T.6 N., R.11 E., [R-31] | N 579970.739 E 2103283.240 |

| CONTROL POINT LIST | | | | |
|--------------------|-----------|--------|--------------|---------------|
| C-1 | AMA-49-PM | 6.79 | N 579428.857 | E 2104700.534 |
| C-2 | AMA-49-PM | 6.98L | N 579474.452 | E 2104404.626 |
| C-3 | AMA-49-PM | 6.98 | N 579728.682 | E 2104649.365 |
| C-4 | AMA-49-PM | 6.98R | N 580029.720 | E 2105339.184 |
| C-5 | AMA-49-PM | 7.42 | N 580253.332 | E 2104147.515 |
| C-6 | AMA-49-PM | 7.42L | N 580135.378 | E 2103339.886 |
| C-7 | AMA-49-PM | 8.05 | N 581191.098 | E 2103743.478 |
| C-8 | AMA-49-PM | 8.05L | N 581449.467 | E 2102982.088 |
| C-9 | AMA-49-PM | 8.82 | N 582096.458 | E 2103127.068 |
| C-10 | AMA-49-PM | 8.82R | N 582403.108 | E 2103396.684 |
| C-11 | AMA-49-PM | 8.82L | N 582259.540 | E 2101869.112 |
| C-12 | AMA-49-PM | 9.26 | N 582686.558 | E 2102958.077 |
| C-13 | AMA-49-PM | 9.26L | N 582852.923 | E 2101717.036 |
| C-14 | AMA-49-PM | 9.72 | N 583231.779 | E 2102226.731 |
| C-15 | AMA-49-PM | 9.72R | N 583801.951 | E 2102418.817 |
| C-16 | AMA-49-PM | 10.51 | N 584229.789 | E 2101467.413 |
| C-17 | AMA-49-PM | 10.51R | N 584590.769 | E 2102252.575 |
| C-18 | AMA-49-PM | 11.05 | N 584706.114 | E 2100756.590 |
| C-19 | AMA-49-PM | 11.05L | N 584610.037 | E 2100395.324 |
| C-20 | AMA-49-PM | 11.05R | N 584963.686 | E 2101213.409 |
| C-21 | AMA-49-PM | 11.44 | N 585207.191 | E 2100363.140 |

| DIST | COUNTY | ROUTE | POST MILES TOTAL PROJECT | SHEET NO. | TOTAL SHEETS |
|------|--------|-------|---------------------------------|-----------|--------------|
| 10 | AMA | 49 | KP R11.3/R17.7 PM R7.0/R11.0 | 2 | 29 |

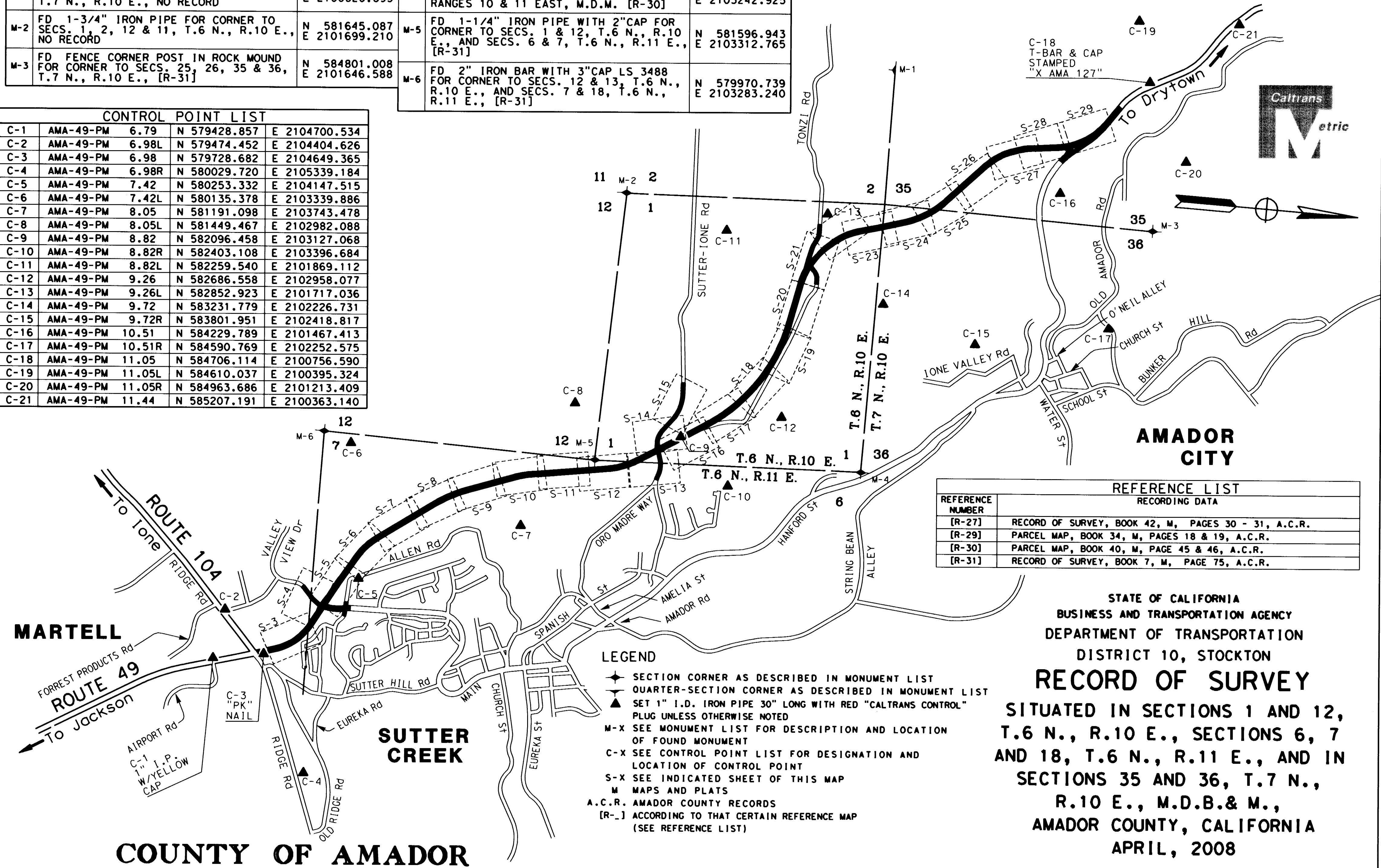

STATE OF CALIFORNIA
BUSINESS AND TRANSPORTATION AGENCY
DEPARTMENT OF TRANSPORTATION
DISTRICT 10, STOCKTON
RECORD OF SURVEY
SITUATED IN SECTIONS 1 AND 12,
T.6 N., R.10 E., SECTIONS 6, 7
AND 18, T.6 N., R.11 E., AND IN
SECTIONS 35 AND 36, T.7 N.,
R.10 E., M.D.B.& M.,
AMADOR COUNTY, CALIFORNIA
APRIL, 2008