

# CORNER RECORD

Agency Index

BK 100 PG 35

Document Number

CR 10395City of EDEN TOWNSHIP

County of

ALAMEDA

, California

Brief Legal Description PIN MONUMENT LOCATED WITHIN VIA KARL

## CORNER TYPE

## COORDINATES (Optional)

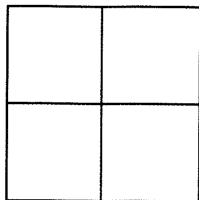

Government Corner

☐

Control

☒

Meander

☐

Property

☐

Rancho

☐

Other

☐N. 2070825± E. 6085698±

Elevation

Units

Metric ☐U.S. Survey Foot ☐

Horizontal Datum

Zone

Epoch Date

Vertical Datum

☐ Complies with Public Resources Code §§8801-8819☐ Complies with Public Resources Code §§8890-8902Date of Survey 6/6/17

PLS Act Ref:

☐ 8765(d)☒ 8771☐ 8773☐ Other:Corner/  
Monument:☒ Left as found☐ Established☐ Rebuilt☐ Pre-Construction☐ Found and tagged☐ Reestablished☐ Referenced☒ Post-Construction

Narrative of corner identified and monument as found, set, reset, replaced, or removed:

☐ See sheet #2 for description(s) : CR 9418

FOUND PIN IN CONCRETE IN MONUMENT WELL.

FOUND AND SET POINTS AS SHOWN ON PAGE 2.

THIS POINT WAS FOUND IN GOOD CONDITION AFTER A CONSTRUCTION PROJECT IN THE VICINITY.  
THE TIES SHOWN HEREON ARE FOR THE PURPOSE OF PERPETUATING FOUND MONUMENTATION.  
NO CLAIM IS MADE AS TO THE RELATIONSHIP OF THE POINTS OR LINES SHOWN HEREON TO TRUE  
BOUNDARY LOCATION.

## SURVEYOR'S STATEMENT

This Corner Record was prepared by me or under my direction in conformance with

the Professional Land Surveyors' Act on JUNE 16, 2017

Signed

P.L.S. or R.C.E. No.

LS 8525

SCOTT V. CUNHA

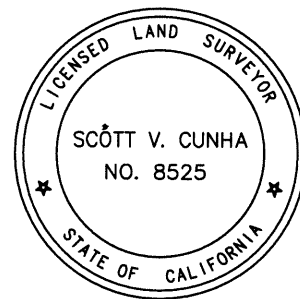

## COUNTY SURVEYOR'S STATEMENT

This Corner Record was received 20 JULY, 2017and examined and filed 24 AUGUST, 2017

Signed

P.L.S. or R.C.E. No.

6843Title COUNTY SURVEYOR

County Surveyor's Comment

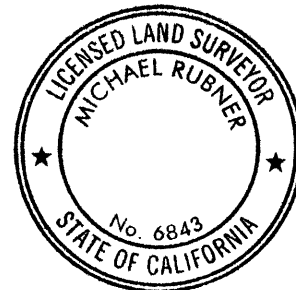

SPEC-2315-POST

SCALE: 1"=30'

## LEGEND

- FOUND IRON PIN IN CONCRETE IN MONUMENT WELL
- ⊗ FOUND CUT CROSS IN WALK
- ✕ FOUND CUT CROSS IN CURB
- ✕ FOUND MAG AND SHINER
- FOUND REBAR & CAP STAMPED "CEI RP"
- AA### ALAMEDA COUNTY MONUMENT ID
- (19592) REFERENCE STREET ADDRESS

