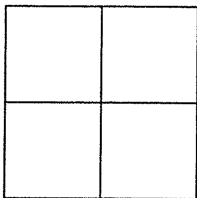

BK 39 Pg 59

CORNER RECORD

Document Number CR 4417City of ALAMEDACounty of ALAMEDA, CaliforniaBrief Legal Description BRASS DISC IN CURB LOCATED IN FRONT OF 3333 FERNSIDE BLVD

CORNER RECORD

Government Corner ☐ Control ☒
 Meander ☐ Property ☐
 Rancho ☐ Other ☐
 Date of Survey 1/7/11

COORDINATES
(Optional)

N. _____
 E. _____
 Zone _____ Datum _____
 Elev. _____

Corner — Left as found ☐ Found and tagged ☐ Established ☐ Reestablished ☐ Rebuilt ☒

Identification and type of corner found: Evidence used to identify or procedure used to establish or reestablish the corner:
SEE PAGE 2.

THIS POINT WAS REFERENCED AFTER A CONSTRUCTION PROJECT IN THE VICINITY.

A description of the physical condition of the monument as found and as set or reset: _____

FOUND AND SET POINTS AS SHOWN ON PAGE 2.

SURVEYOR'S STATEMENT

This Corner Record was prepared by me or under my direction in conformance with
 the Land Surveyors' Act on JANUARY 10, 2011.

Signed Vincent H. Cunha L.S. Number L5 4520

VINCENT H. CUNHA



COUNTY SURVEYOR'S STATEMENT

This Corner Record was received _____ 20____ and examined

and filed 3-24-2011

Signed Russell R. Penland Jr. Title COUNTY SURVEYOR

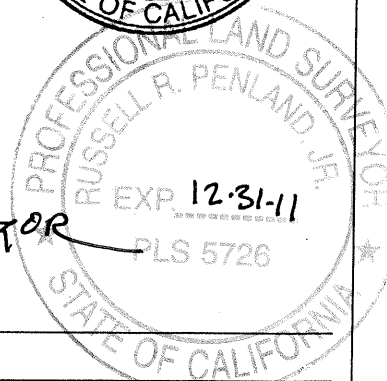

County Surveyor's Comment _____

LEGEND

- ⊗ -FOUND BRASS DISC IN CURB STAMPED
"CORP OF ENGINEERS"
"TC 365"
"196/0/S"
YEAR 1981
-REPLACED WITH NAIL AND TAG
LS4520 IN CONCRETE DRIVEWAY
- ✱ FOUND NAIL AND TAG LS 4520
(PER CR 4300)

SCALE : 1"=40'

